

<b>Transport Dimension</b>	l/w/h	4950/2450/3500
<b>Hitch</b>		
rotation speed of PTO	rpm	1000
Mount in 3-point linkage	Category	II + III
<b>Hydraulicconnection</b>		
Conveyor up / down, Discharge Flap up / down		1x double action actions with manuel valve changeable
<b>chassis</b>		
		4 fixed wheels optional: lag steering of the 2 rear wheels
Total Weight	kg	3600
<b>Millingrotor</b>		
Rotor	kg	approx. 400
Weight equipped	mm	2900
Width	mm	760
Diameter	rpm	315
Knives / Millingbit	pieces	26 / 2
maximum Millingdepth	mm	up to 500; dependet on tractor performance and
<b>Austragsband (Gummiband)</b>		
Dropping height	mm	3000
Width	mm	1000
Rotation Speed at 1000 rpm PTO	m/s	6,6
<b>Traktor Mindestanforderungen</b>		
Performance	kW/PS	from 96 / 130
	kW/PS	up to 220 / 300
Speed	km/h	from 0,5



**Throughput**

Compost

m<sup>3</sup>/h

bis zu 1200

**Configuration**

"Walterscheid" Powertrain "Powerdrive" ·

selectable Connection profile (s. page 3) ·

Maintenance flap ·

Special Paint °

Lap Steering °

· series

° option



selectable Connection profile

Willibald PN

rude  
1 3/8"  
6-teilig

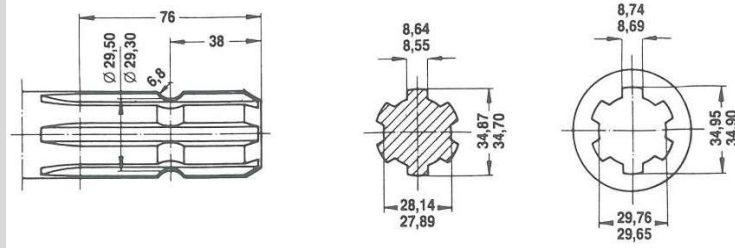

125-04-140

fine  
1 3/8"  
21-teilig

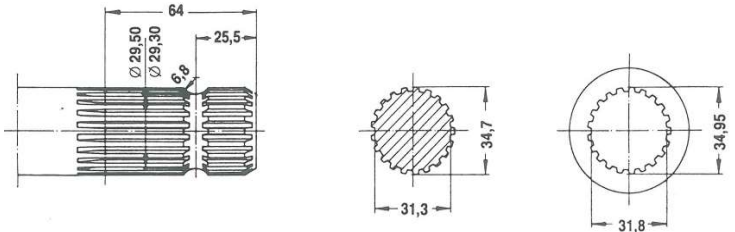

125-04-142

rude  
1 3/4"  
6-teilig

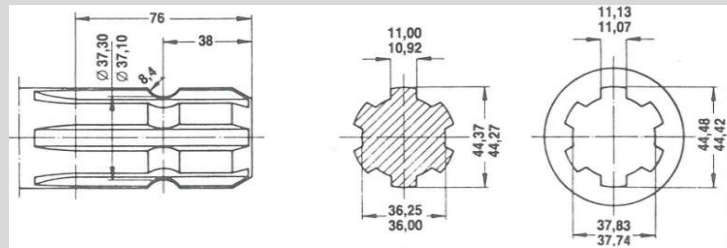

125-04-144

fine  
1 3/4"  
20-teilig

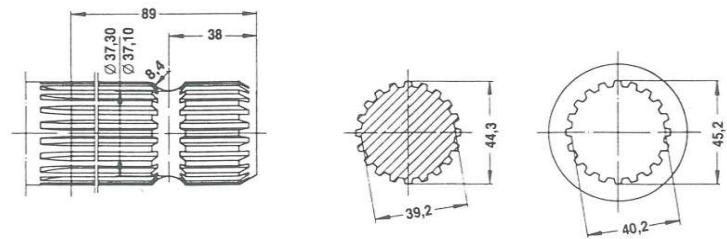

125-04-146