

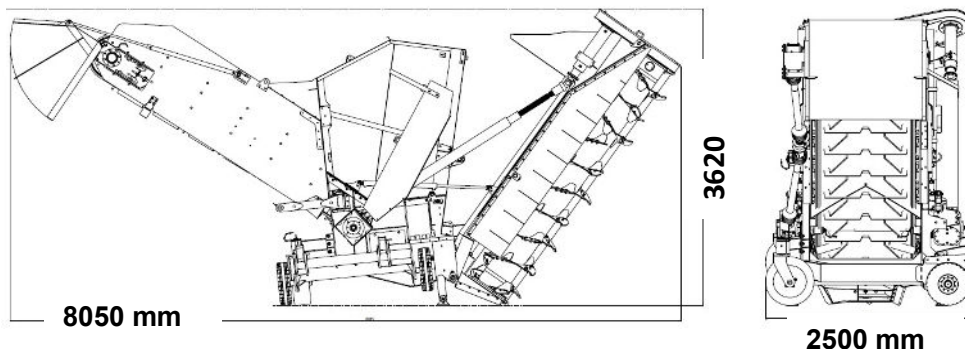

Transport position:

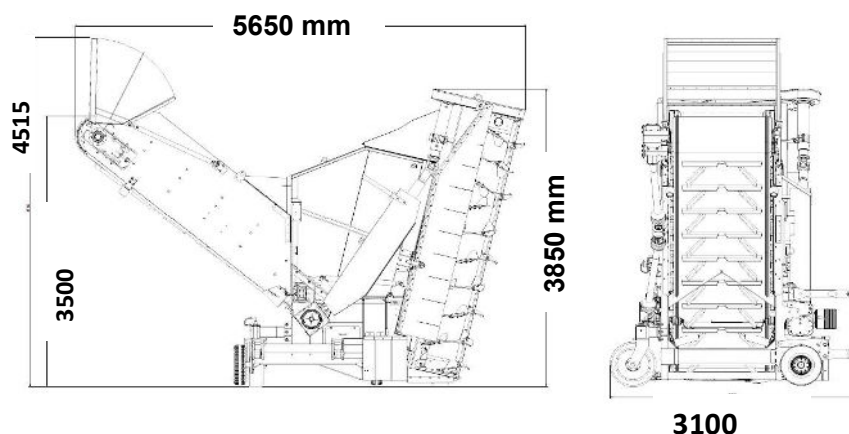

working position:



Transport Dimension	I/w/h	8050/2500/3620
Hitch		
rotation speed of PTO	rpm	1000
Mount in 3-point linkage	Category	III in the 3-point linkage of tractor
Hydraulic connection		
swivel drum / Hydr. supporting wheel up / down, Discharge Flap up / down (tractor driven)		2x double action
chassis		
		2 fixed wheels 2 swiveling wheels
Total Weight	kg	5500
Millingrotor		
Rotor	kg	approx. 500
Weight equipped	mm	3400
Width	mm	800
Diameter	rpm	330
Knives / Millingbit	pieces	35 / 2
maximum Millingdepth	mm	up to 600; in dependance of tractor performance &
discharge conveyor (rubber belt)		
Dropping height	mm	4000
Width	mm	1200
Rotation Speed at 1000 rpm PTO	m/s	7
Tractor minimum requirements		
Performance	kW/PS	from 132 / 180
	kW/PS	up to 220 / 300
Speed	km/h	up to 1,5



Throughput

Compost

m³/h

up to 1500

Configuration

"Walterscheid" Powertrain "Powerdrive" •

selectable Connection profile (s. page 3) •

Maintenance flaps •

Special Paint °

selectable Connection profile

Willibald PN

rude
1 3/8"
6-parts

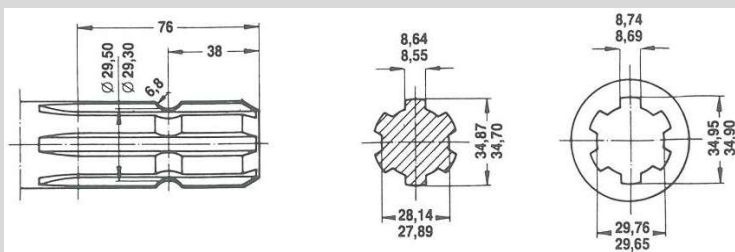

125-04-140

fine
1 3/8"
21-parts

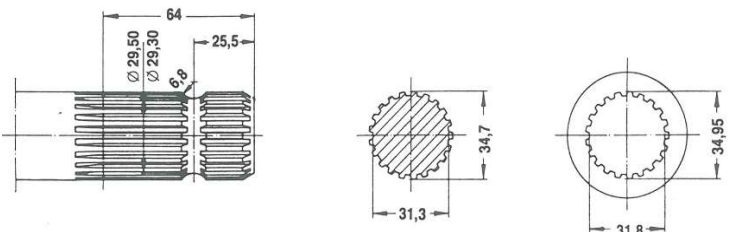

125-04-142

rude
1 3/4"
6-parts

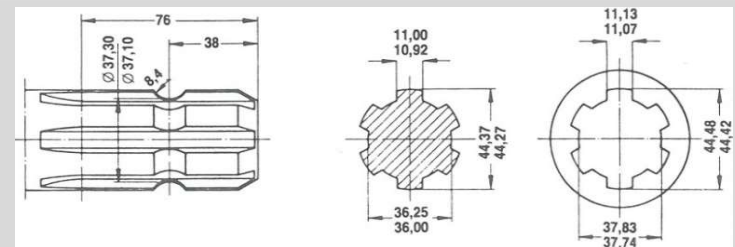

125-04-144

fine
1 3/4"
20-parts

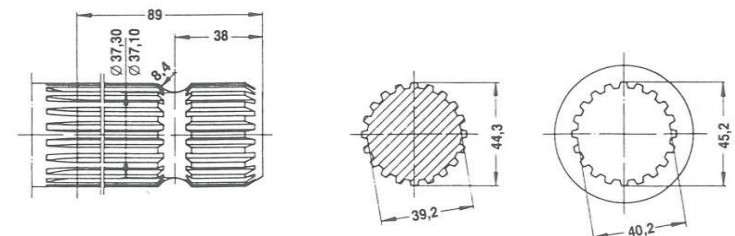

125-04-146

- series
- ° option